



Ashfield Road, London, Greater London, N14

£750,000

7JY



Ashfield Road, Southgate, London N14

Discover this charming semi-detached 3-bedroom house with an adjacent garage, nestled in one of Southgate's premier locations.

This delightful residence features two spacious reception rooms adorned with laminate flooring, efficient gas central heating, two generously sized bedrooms, along with a sizable single room.

Additional highlights include a convenient downstairs toilet, double glazing throughout, and a fully tiled three-piece bath suite.

The large kitchen, complete with a separate dining section, enhances the appeal of this property. Benefit from off-street parking and a spacious rear garden with a patio, perfect for relaxation.

Situated just a short stroll away from The Green's shopping amenities, this home offers both convenience and accessibility, being a mere 10-minute walk from Arnos Grove tube station (Piccadilly Line) or Southgate Station. Don't miss the opportunity to explore this remarkable property – a must-see!



Ashfield Road- N14

Approximate Gross Internal Area 117.4 m² ... 1263 ft² (excluding garden)

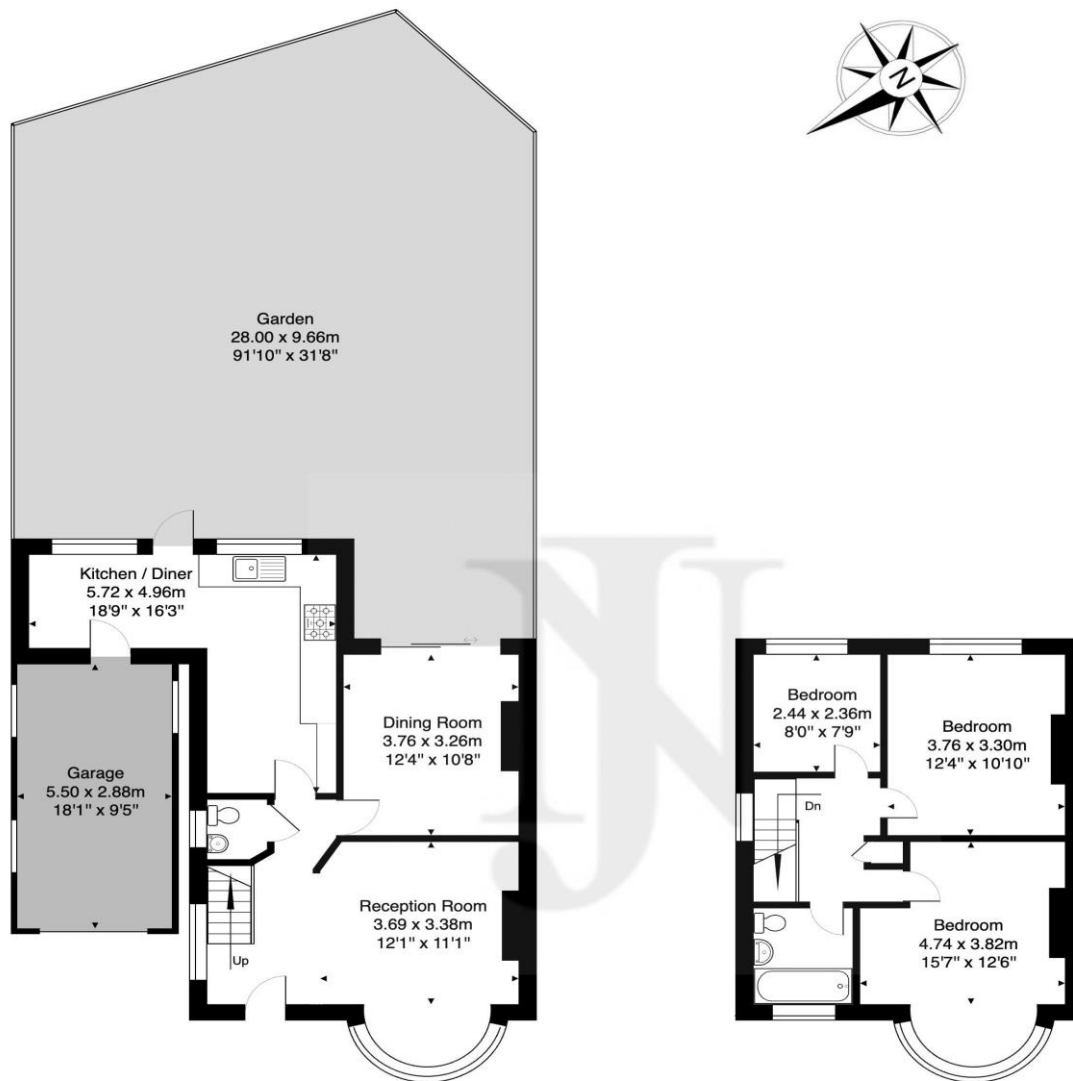

Nicholas James

"Honesty is the only investment that never fails"

Tel: 020 8886 9462

34 High Street Southgate London Greater London N14 6EE

info@njestates.co.uk

www.njestates.co.uk

All details including floorplans are for representation purposes only and do not constitute a contract or a warranty. Whilst every effort has been made to ensure accuracy of descriptions and measurements, no responsibility is taken for errors, omissions and misstatements.



GROUND FLOOR

FIRST FLOOR

This Plan is for illustration purpose only and used as general indication of the proposed layout of the property. Dimensions are maximum and approximate and may vary.

Copyright One Square Space Ltd